

D & H PAVING LLC

485 Kennedy Rd.
Cheektowaga, NY 14227

716-893-0066 716-892-1486

Estimate

Date	Estimate #
4/27/2021	16163

Name / Address
Ellicottville Inn Condominiums 10 Washington Street Ellicottville, NY 14731

Ship To
Ellicottville Inn Condominiums 10 Washington Street Ellicottville, NY 14731

Project	Option #1 2021	Terms	Upon completion
---------	----------------	-------	-----------------

Description	Qty	Cost	Total
Rebate Mill transition sections at adjoining pavement surfaces. Remove spoils from site. Clean entire blacktop surface of parking lot and driveways Apply coat of hot tack to all areas to be paved. True and level entire area with shim coat. Resurface entire area with 1½" finish commercial type 7 top. Install parking and control lines as per original layout. Above area approx. 8,150 sq.ft. Cost to complete above.		20,872.50	20,872.50
NOTE; ASPHALT INDEX \$518.00. PRICE IS SUBJECT TO CHANGE DUE TO FLUCTUATION IN ASPHALT INDEX CAPITAL IMPROVEMENT TO REAL PROPERTY- CERTIFICATE REQUIRED			0.00

Thank you for letting us quote this work. THIS QUOTE GOOD FOR 30 DAYS	Total	\$20,872.50
---	--------------	-------------

Signature _____

D & H PAVING LLC

Estimate

485 Kennedy Rd.
Cheektowaga, NY 14227

716-893-0066 716-892-1486

Date	Estimate #
4/27/2021	16164

Name / Address
Ellicottville Inn Condominiums 10 Washington Street Ellicottville, NY 14731

Ship To
Ellicottville Inn Condominiums 10 Washington Street Ellicottville, NY 14731

Project	Option #2 2021	Terms	Upon completion
---------	----------------	-------	-----------------

Description	Qty	Cost	Total
Excavate all loose debris, broken blacktop and stone from entire surface. Install layer of stabilization fabric to area prior to stone . Install 8" crushed stone base and compact to a firm foundation Pave entire area with 2" layer of type 3 commercial binder Resurface entire area with 1" finish commercial type 7 top. Install parking and control lines as per original layout. Above area approx. 8,150 sq.ft. Cost to complete above.		54,213.75	54,213.75
NOTE; ASPHALT INDEX \$518.00. PRICE IS SUBJECT TO CHANGE DUE TO FLUCTUATION IN ASPHALT INDEX			
CAPITAL IMPROVEMENT TO REAL PROPERTY- CERTIFICATE REQUIRED			0.00

Thank you for letting us quote this work. THIS QUOTE GOOD FOR 30 DAYS	Total	\$54,213.75
---	--------------	-------------

Signature _____

D & H PAVING LLC

Estimate

485 Kennedy Rd.
Cheektowaga, NY 14227

716-893-0066 | 716-892-1486

Date	Estimate #
4/27/2021	16165

Name / Address
Ellicottville Inn Condominiums 10 Washington Street Ellicottville, NY 14731

Ship To
Ellicottville Inn Condominiums 10 Washington Street Ellicottville, NY 14731

Project	Concrete in front of dumpster pad 2021	Terms	Upon completion
---------	--	-------	-----------------

Description	Qty	Cost	Total
Saw cut existing blacktop to required depth Excavate all loose debris, broken blacktop and stone from entire surface. Install layer of stabilization fabric to area prior to stone . Install 6" crushed stone base and compact to a firm foundation Install wire mesh Install new 8" high early concrete Cost to complete above.		7,000.00	7,000.00T
NOTE: If completed at the same time as paving project this will become a part of the capital improvement. Sales Tax Cattaragus County 8.00%		8.00%	560.00

Thank you for letting us quote this work. THIS QUOTE GOOD FOR 30 DAYS	Total	\$7,560.00
---	--------------	------------

Signature _____

Ellicottville Inn Condominiums
Parking Lot Repair/Replacement Quotes

Two Options

Option 1:

Scope:

Repair Only (Inner Lot)
Striping (Inner & Outer Lot)

Detail method:

Describe what areas will be repaired and how they will be repaired.
Are materials NYSDOT approved? *Yes*

Timeframe:

How long will it take?
When could you start?

Terms and Conditions:

Warranty?
Payment terms.

Option 2:

Scope:

Full Replacement (Inner Lot)
Striping (Inner & Outer Lot)
Garbage Pad Recommendations

Detail method:

Describe how the area will be prepared, thickness of asphalt, etc.
Are materials NYSDOT approved?

Timeframe:

How long will it take? *concrete 2days Paving 1day*
When could you start? *when u need us to*

Terms and Conditions:

Warranty?
Payment terms. *upon completion*

Quotes Due On or Before Friday 23-April

NO.	DATE	REVISIONS	QUANTITY
01		ISSUED FOR PERMITS	1
02		ISSUED FOR CONSTRUCTION	4
03		ISSUED FOR CONSTRUCTION	5

PLANTING SCHEDULE

Young & Rubicam Architects
 Larkin Building
 728 Exchange Street, Suite 812
 Buffalo, NY 14203
 P.O. Box 1100
 P.O. Box 1100
 P.O. Box 1100
 P.O. Box 1100
 P.O. Box 1100

Consultants

Project Information
RENOVATIONS TO:
ELLIOTTVILLE INN
40 WASHINGTON ST.
ELLIOTTVILLE, NY
14731

NO.	DATE	DESCRIPTION
1		
2		
3		
4		
5		
6		
7		

Project No. 0018
 Drawing Title SA101.pdf
 Drawn By J
 Checked By J
 Copyright 2007, Young & Rubicam, LLC
 Sheet Title
PROPOSED SITE PLAN

Sheet No.
SA101

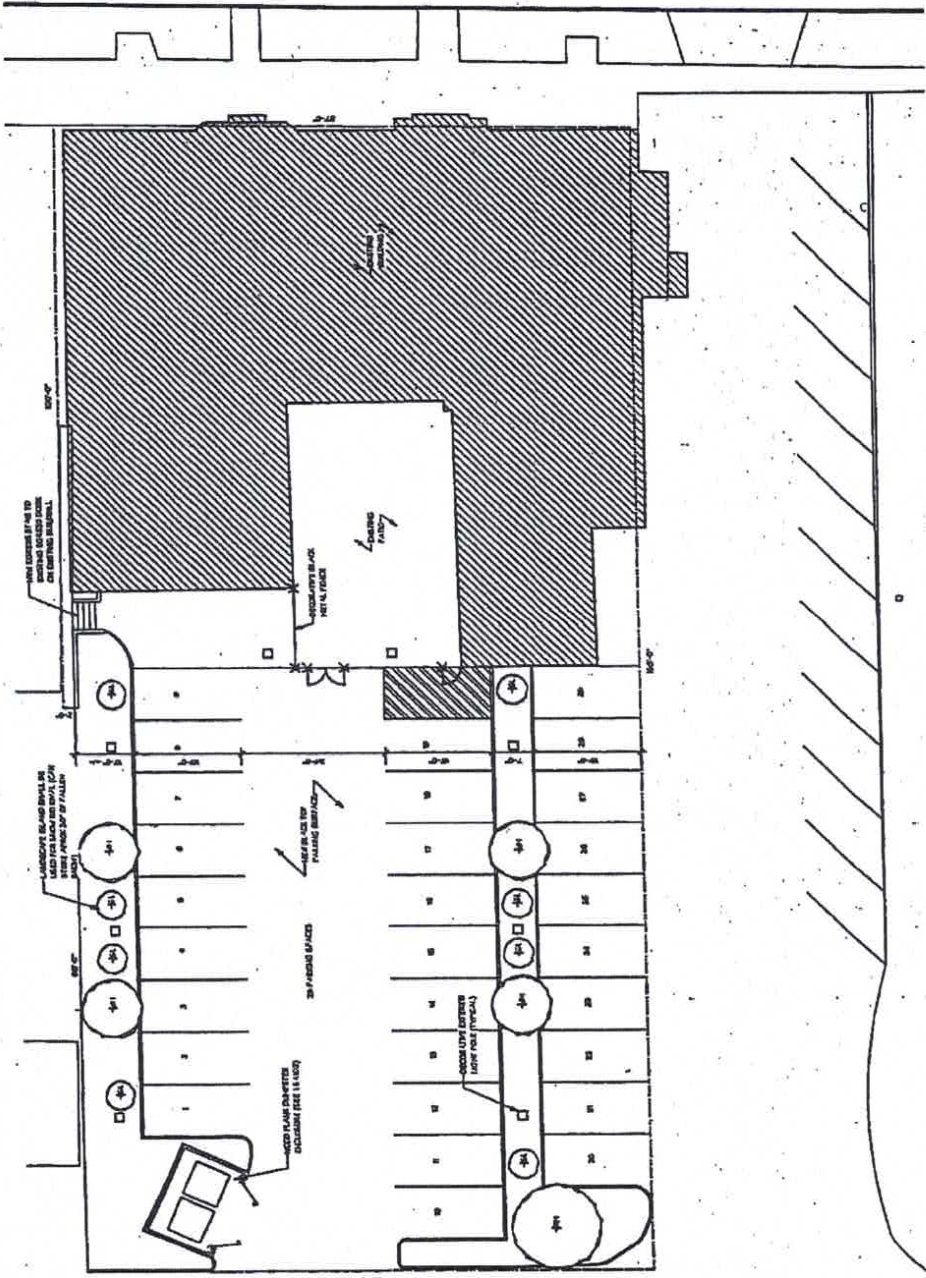

1 SITE PLAN
 SCALE: 1/8" = 1'-0"



To: Peters And Moriarity	Contact: Kathleen Moriarity
Address: 8 Washington St Ellicotville, NY 14731	Phone: (716) 699-2355
Project Name: Peters And Moriarty	Fax:
Project Location: 8 Washington St, Ellicotville, NY	Bid Number: 107-121
	Bid Date: 11/12/2020

Item Description	Estimated Quantity	Unit
Milling Depth 4 Inches	5,400.00	SF
Milling Clean Up And Edge Milling Along Curb Lines	5,400.00	SF
Fine Grade For Asphalt Paving	5,400.00	SF
Fine Grade/Prep For Concrete Dumpster Pad	535.00	SF
Asphalt Paving - Install Type 3 Binder 2.5 Inches	85.00	TON
Asphalt Paving - Install Type 7F Top 1.5 Inches	54.00	TON
Parking Lot Striping	1.00	LS
Concrete Pavement 8" For Dumpster Pad	675.00	SF

Total Bid Price: \$38,470

- Notes:**
- The above prices do not include Permits.
 - Our price is based on the current cost of asphalt. The actual price will be based on the cost of asphalt at the time of installation.
 - All material thicknesses specified, are compacted thicknesses. All materials are NYSDOT approved.

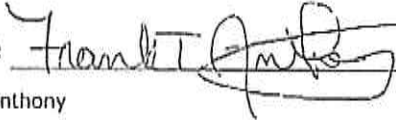
<p>ACCEPTED: The above prices, specifications and conditions are satisfactory and are hereby accepted.</p> <p>Buyer: _____</p> <p>Signature: _____</p> <p>Date of Acceptance: _____</p>	<p>CONFIRMED: Lake Shore Paving, Inc.</p> <p>Authorized Signature: </p> <p>Estimator: Frank T. Anthony</p>
---	---



Kingsview Enterprises, Inc.
 7 West First Street
 PO Box 2
 Lakewood NY 14750
 Ph.: 716-763-0069
 Fax: 716-763-4722
 teresa@kingsviewpaving.co
 m

Estimate

Date	Estimate #
11/16/2020	47417

Name / Address

KATHLEEN MORIARTY
 8 WASHINGTON ST
 ELLICOTTVILLE NY 14731

Customer Information			Project			
Customer Phone	Customer Alt. Phone	Customer Fax				
716-699-2355						
Description			Qty	U/M	Rate	Total
PATCH ALL HOLES Asphalt Repair. 1. Power clean surface of all dirt and debris. 2. Apply asphalt Type 7 to level consistency and roll. 1. Remove all loose aggregate and compact sub-grade. 2. Milling of surface as needed to acquire a smooth & level transition and provide proper water drainage and/or use of hand compressor with air gun. 3. Segment shall then be filled with NYS DOT approved asphalt binder Type 3 and rolled to a 0" to 6" depth depending on variations in asphalt thickness. 4. Power clean surface of all dirt and debris. 5. All bordering areas shall be cleared of any overgrowth onto existing pavement. 6. Apply NYS DOT approved asphalt binder to level all areas and compact - tac-coat existing perimeters. 7. Pave 1-1/2" of Armor-Coat top coat and hand tamp & bevel all edges.					900.00	900.00T
Sales Tax					8.00%	1,112.00